

Geolift 4200 Four Post Lift

Technical Data Sheet

The Staple 4 Post Alignment Lift from Hofmann Megaplan

- Electro-hydraulic operation with synchronization cables means the platforms stay perfectly level with each other
- Air locking release offers instantaneous control and failsafe reliability
- Front wheel stops can easily be replaced by optional drive-off ramps
- Bolt-on alignment kit included as standard for alignment type

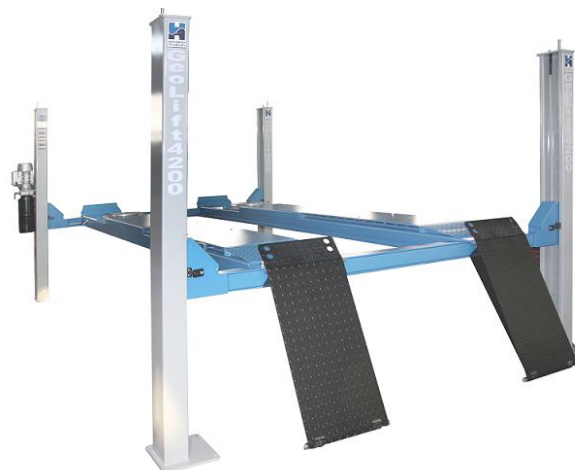

| | |
|--|----------------|
| Lift Capacity | 4200kg |
| Max. Raised Height: Standard Type | 1800mm |
| Max. Raised Height: Alignment Type | 1800mm |
| Min. Lowered Height: Standard Type | 130mm |
| Min. Lowered Height: Alignment Type | 180mm |
| Runway Length | 4808mm |
| Runway Width | 512mm |
| Free Width Between Runways | 912mm |
| Width Between Two Columns | 2850mm |
| Overall Length (ex. Run up ramps) | 5038mm |
| Overall Length (inc. Run up ramps) | 5920mm |
| Overall Height | 2263mm |
| Overall Width | 3154mm |
| Raised Time | 60s |
| Noise Level | 80 dB (A)/1m |
| Rated Pneumatic Pressure | 6bar - 8bar |
| Working Temperature | -10 °C - 40 °C |
| Average Weight of Package Standard | 1250kg |
| Average Weight of Package Alignment | 1870kg |



Tel: 01480 8 9 10 11

Email: enquiries@hofmann-megaplan.co.uk

www.hofmann-megaplan.co.uk

Unit 13 Brook Road, Bicton Industrial Estate, Kimbolton, PE28 0LR

Geolift 4200 Four Post Lift

Technical Data Sheet

Geolift 4200 Dimensions:

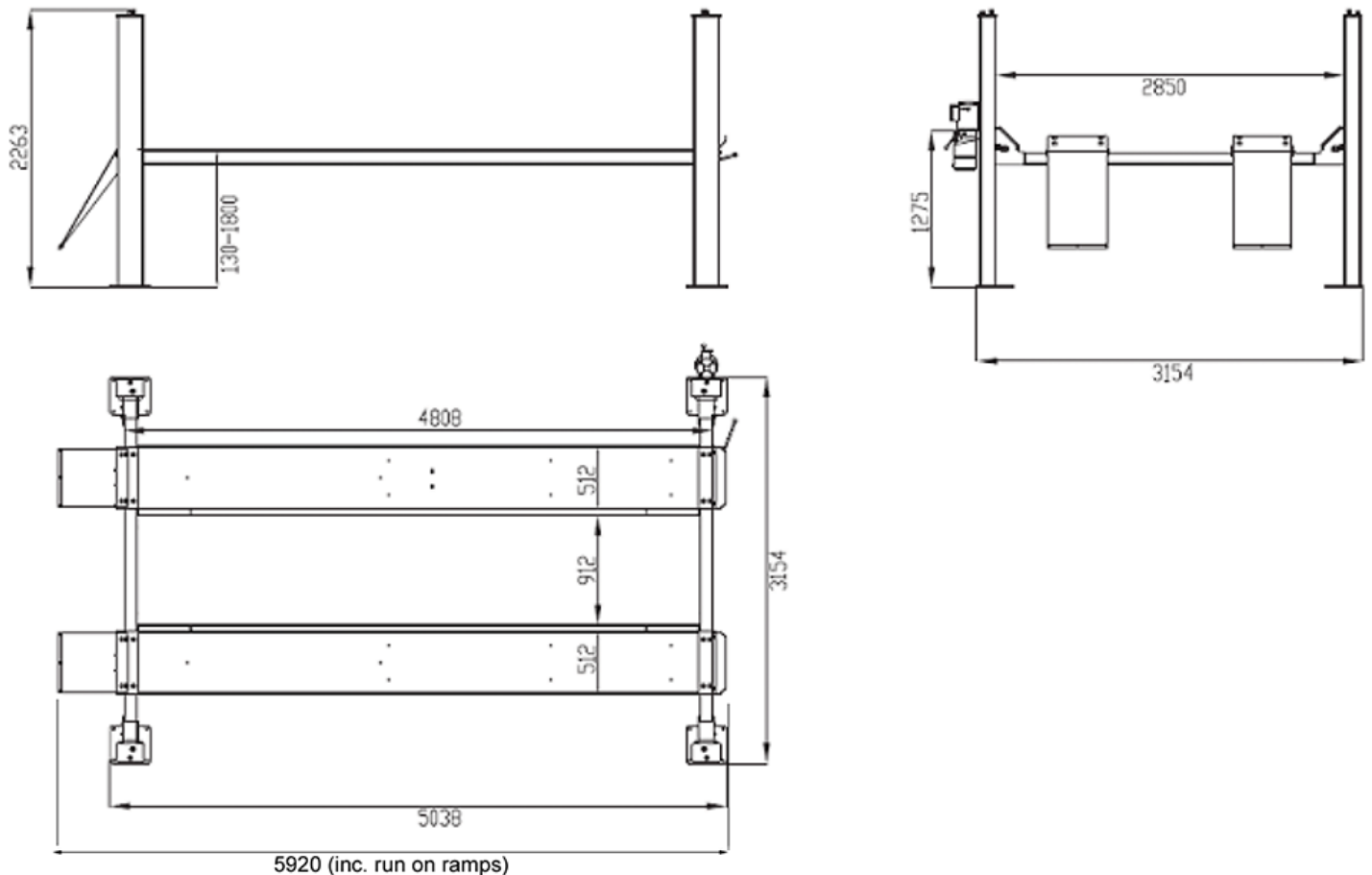

Additional Information:

- Overall length including run up ramps of 5920mm
- Available in 1 or 3 Phase
- Homologated and certified product according to the European Directive EN1493:2010



Tel: 01480 8 9 10 11

Email: enquiries@hofmann-megaplan.co.uk

www.hofmann-megaplan.co.uk

Unit 13 Brook Road, Bicton Industrial Estate, Kimbolton, PE28 0LR